

Infrastructure

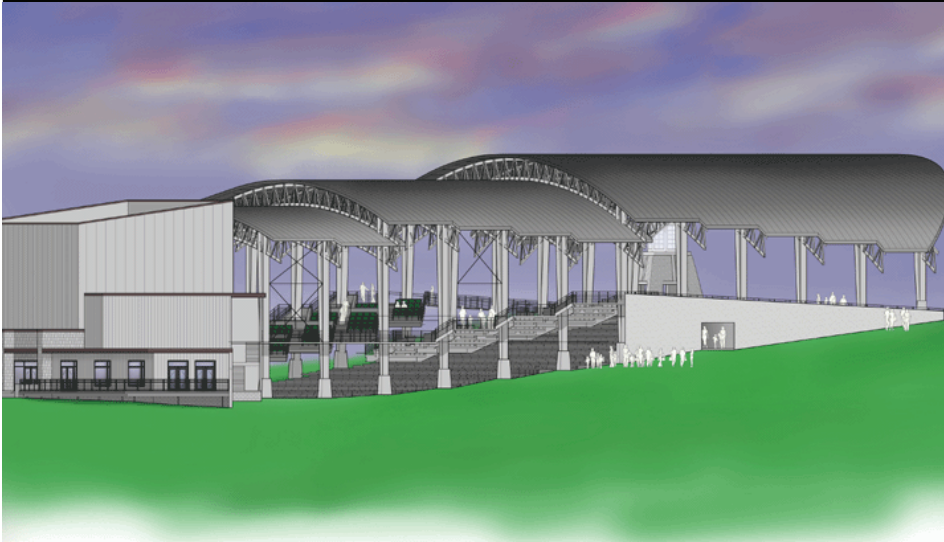

Marvin Sands Performing Arts Center Canandaigua, New York

Amphitheatres

Formerly the Finger Lakes Performing Arts Center, the Constellation Brands - Marvin Sands Performing Arts Center, or CMAC for short, is located on the grounds of Finger Lakes Community College. It has served as the summer home to the Rochester Philharmonic Orchestra and been host to a variety of events and performances since the early 1980's. In 2005, construction began to modernize and upgrade the amphitheatre with state-of-the-art features and an expanded seating capacity.

Carpenter Wright Engineers provided the structural design of the roof framing for the approximately 40,000 square foot facility. The structure includes curved roof trusses, tapered building columns, longitudinal bracing and roof joists.



Fabricator: *Qualico Steel Company, Inc.*

CWE Design Offices:

**Nashville
Knoxville**